

# BONDT rectangular

ZEITRAUM

## Assembly instructions 03/2021

### TOOLS:

allen key SW4 and SW5 (enclosed)

- 16 x XS steel bolts
- 16 x connector housings
- 16 x grub screws
- 10 x flat-head screws

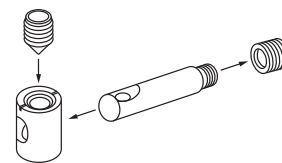
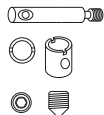

Prior to assembly insert and turn XS bolts into pieces A.

Insert connector housings into all the other planks.

When aligning the housings, ensure that the slots point towards the intersecting holes.

Video:  
<http://www.scheulenburg-direkt.de/index.php?page=content&colD=11>

Please assemble the table **on a soft surface (e.g. a carpet or blanket)** to avoid damages.

## ASSEMBLY OF THE FRAME

1. Connect planks B and C to plank A and fix them with grub screws.
  2. Take the second plank A and connect it with plank C and B with grub screws.
- If you cannot tighten the connection, loosen the grub screw and unscrew the bolt by one or two turns. Then connect again.

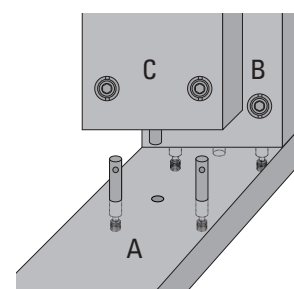
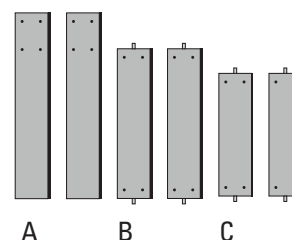

## SCREW FRAMES ON THE TABLE TOP

- Spread a blanket and put the table top upside down on the blanket.
- Place the frames on the table top and fix them with the enclosed pan-head screws.

