

Assembly instructions 05/2021

TOOLS:

allen key SW4 and SW5 (enclosed)

6 x XS steel bolts

6 x XS steel bolts

12 x connector housings

12 x grub screws



2 x countersunk screws (5x60)

24 x confirmat screws

2 x countersunk bolts (M8x50)

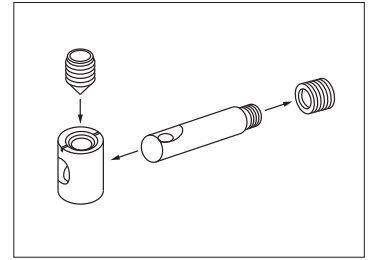

Watch this video for further information on the metal fitting:
<https://www.youtube.com/watch?v=ioIUTDqvgE>

Please assemble the bed **on a soft surface (e.g. a carpet or blanket)** to avoid damages.

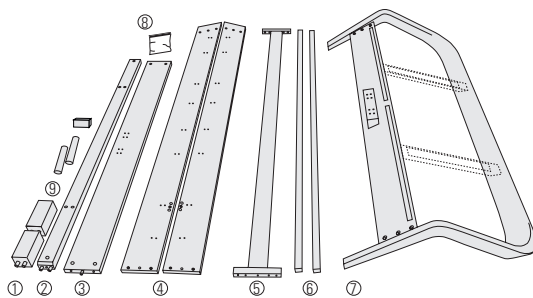

- 1 bases
- 2 crossbar
- 3 footboard
- 4 side rails
- 5 center rail

- 6 support bars
- 7 headboard (vertical ledges up to 160 cm mattress width)
- 8 screws and fittings
- 9 middle feet and spacer block

1. Screw the XS bolts into the side rails (4) and insert the connector housings into the footboard (3) and crossbar (2). Connect the two parts. **The footboard needs to be turned correctly:** The drillings in the middle are on the lower edge side.

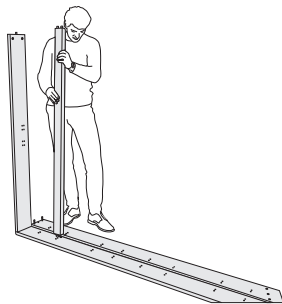

2. Mount the crossbar (2) to the side rail.

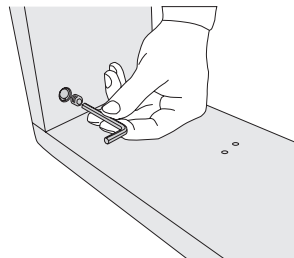

3. Fix the connections with grub screws.

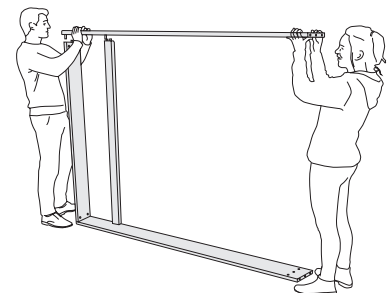

4. Attach the second side rail and fix it with grub screws. Also mount the bases (1).

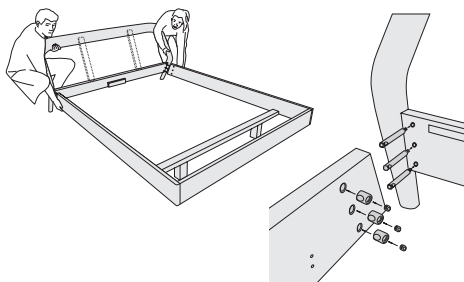

5. Insert the long XS bolts into the headboard (7) and the connector housings into the bed frame. Connect the two parts and fix them using grub screws.

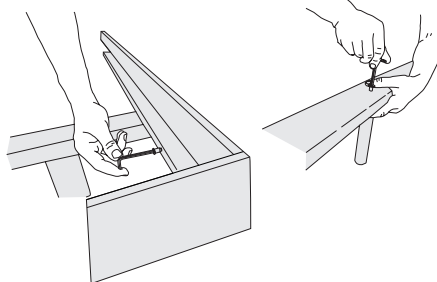

6. Attach the support bars (6) to the side rail using confirmat screws. If available, mount the center rail (5) and middle feet with the countersunk bolts.

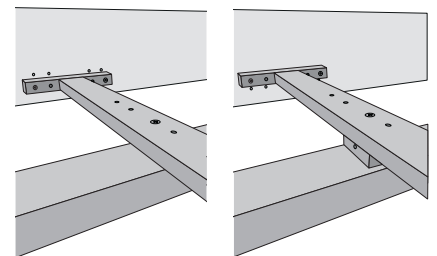

without spacer block: insertion depth 10,5 cm
horizontal spacer block: insertion depth 8,5 cm
Use the countersunk screws to fix the spacer block.