

Assembly instructions 01/2022

TOOLS:

allen key SW4 and SW5 (enclosed)

6 x XS steel dowels

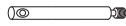

2 x countersunk bolts (M8x50)



6 x XS steel dowels



2 x center support feet, adjustable

12 x connector housings



1 x countersunk screws (5x60)



12 x grub screws



1 x distance block

24 x Confirmat screws

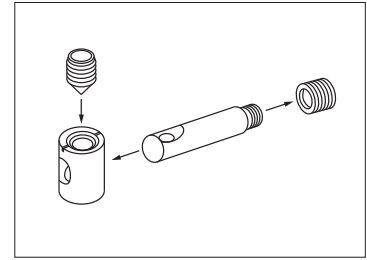

Watch this video for further information on the metal fitting:
<https://www.youtube.com/watch?v=ioIUTDqtvGE>

Please assemble the bed **on a soft surface (e.g. a carpet or blanket)** to avoid damages.

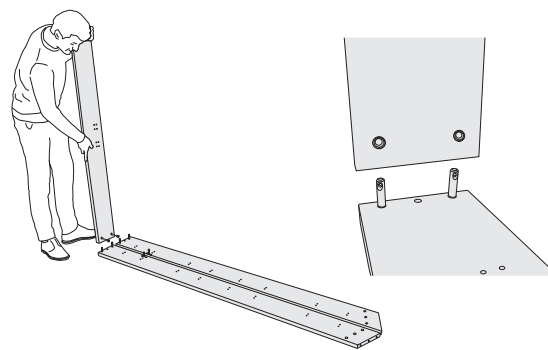
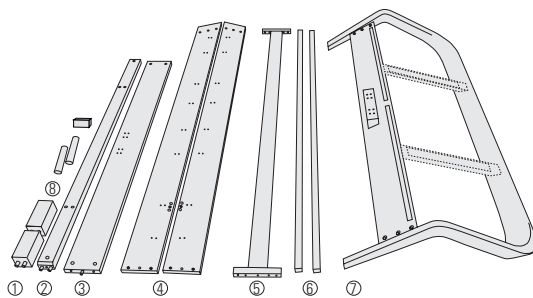

- 1 bed feet
- 2 crossbar
- 3 footboard
- 4 side rails

- 5 center rail
- 6 support bars
- 7 headboard
- 8 center support feet and distance block

1. Screw the short XS dowels into the side rails (4) and insert the connector housings into the footboard (3) and crossbar (2). Connect the two parts. **The footboard needs to be turned correctly:** The drillings in the middle are on the lower edge side.

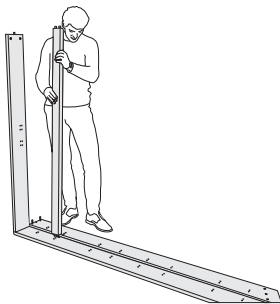

2. Mount the crossbar (2) to the side rail.

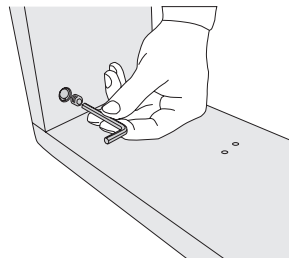

3. Fix the connections with grub screws.

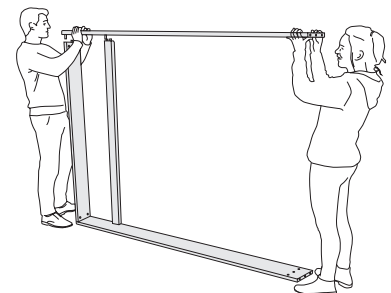

4. Attach the second side rail and fix it with grub screws. Mount the bed feet (1).

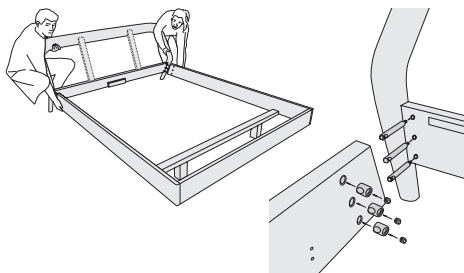

5. Insert the long XS dowels into the headboard (7) and the connector housings into the bed frame. Connect the two parts and fix them using grub screws.

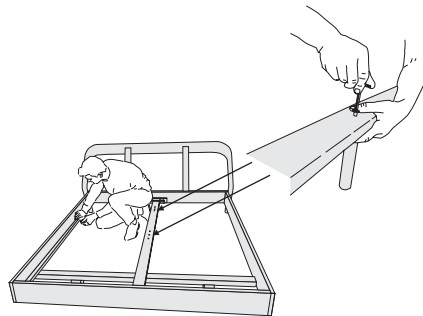

6. Attach the support bars (6) to the side rails using Confirmat screws. Mount the center rail (5) and center support feet (8) with the countersunk bolts (M8x50).

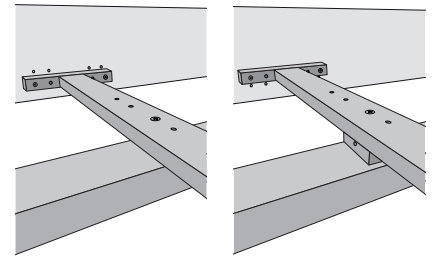

without distance block: insertion depth 10,5 cm
horizontal distance block: insertion depth 8,5 cm
Use the countersunk screws (5x60) to fix the distance block (8).