

# RAIL Snack

tabletop up to 90x90 cm

**ZEITRAUM**

## Assembly instructions 07/2022

### TOOLS:

Allen key SW 5 (enclosed)

6x XS steel dowels (M6)

8x XS steel dowels (M8)

14x connector housings

14x grub screws

1x cylinder head screw (M8x60) with flat washer

1x dowel (8x30)

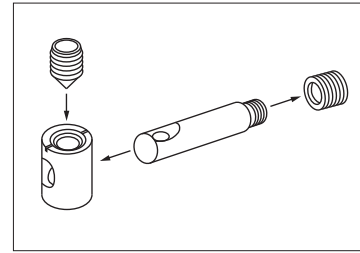
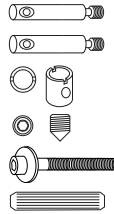

Video:  
<http://www.scheulenburg-direkt.de/index.php?page=content&colD=11>

Please assemble the table **on a soft surface (e.g. a carpet or blanket)** to avoid damages.

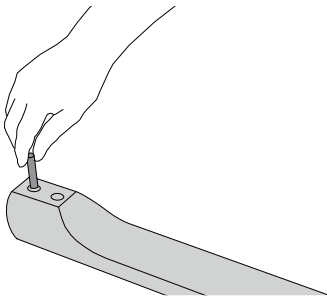

**1.** Screw in the XS steel dowels (M8).

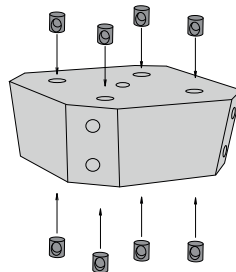

**2.** Insert the connector housings

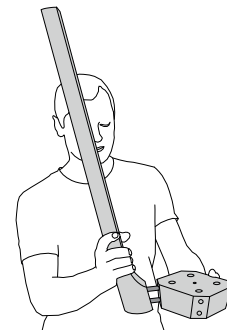

**3.** Join a leg with the mounting block.

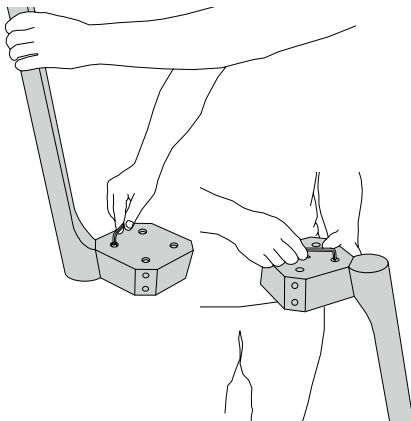

**4.** Tighten the grub screws on both sides of the block.

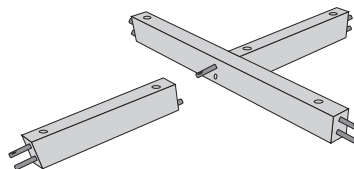

**5.** For the lower cross, screw in the XS steel dowels (M6) and insert the connector housings. Join the parts and tighten the grub screws.

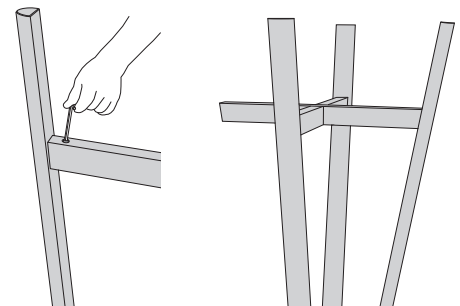

**6.** Mount the cross to the leg. Afterwards, mount the remaining legs. Assembly is easier when the table is upside down.

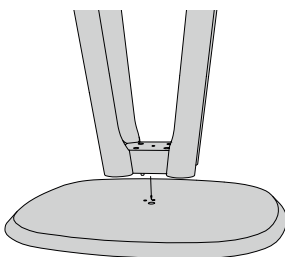

**7.** Position the legs on the tabletop.

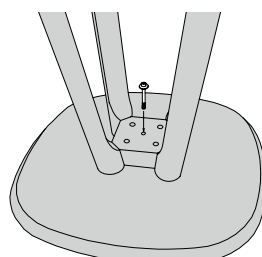

**8.** Insert the cylinder head screw with the flat washer.

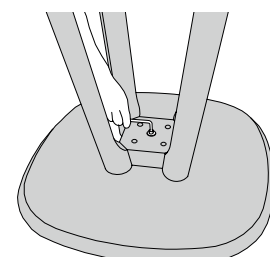

**9.** Tighten the screw.

# RAIL Snack

tabletop bigger than 90x90 cm

**ZEITRAUM**

## Assembly instructions 07/2022

### TOOLS:

Allen key SW 5 (enclosed)

10x XS steel dowels (M6)

8x XS steel dowels (M8)

18x connector housings

18x grub screws

8x cylinder head screws (M6x50) with flat washers

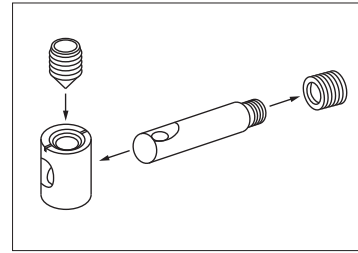
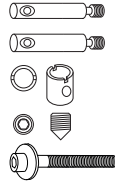

Video:  
<http://www.scheulenburg-direkt.de/index.php?page=content&colD=11>

Please assemble the table **on a soft surface (e.g. a carpet or blanket)** to avoid damages.

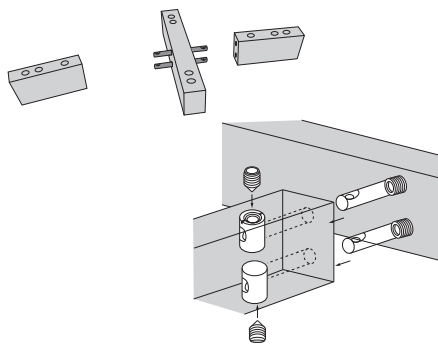

**1.** Assemble the small cross. Screw in the XS steel dowels (M6), insert the connector housings and connect the parts.

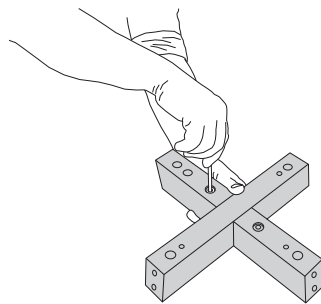

**2.** Fix the connection with grub screws.

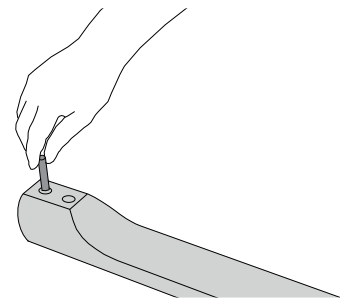

**3.** Screw in the XS steel dowels (M8) into the legs.

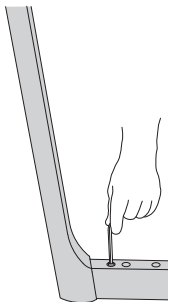

**4.** Push the cross onto the leg and fix the connection with grub screws.

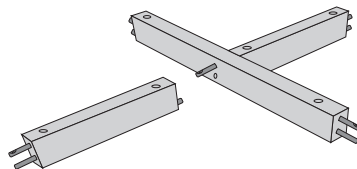

**5.** For the lower cross, screw in the XS steel dowels (M6) and insert the connector housings. Join the parts and tighten the grub screws.

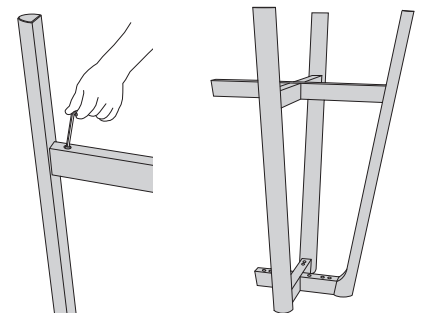

**6.** Mount the lower cross to the leg. Afterwards, mount the remaining legs. Assembly is easier when the table is upside down.

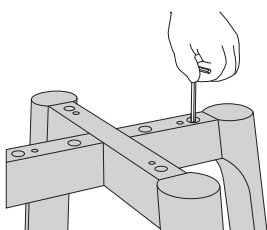

**7.** Fix all grub screws on the top side of the frame.

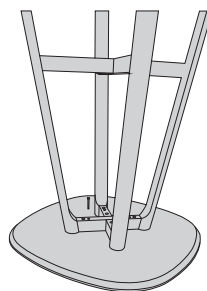

**8.** Place the frame on the tabletop. Insert the cylinder head screws with the flat washers.

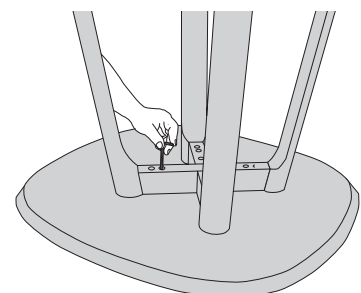

**9.** Tighten the screws.