

RAIL Café

RAIL Dine

tabletop up to 90x90 cm

ZEITRAUM

Assembly instructions 09/2022

TOOLS:

Allen key SW 5 and SW 6 (enclosed)

8x XS steel dowels (M8)

8x connector housings

8x grub screws

1x cylinder head screw (M8x60) with flat washer

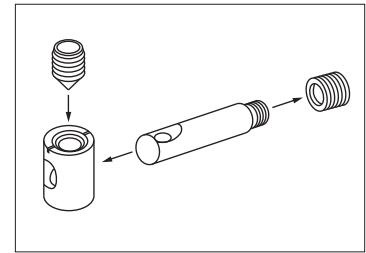

video:
<https://www.youtube.com/watch?v=iolUTDqtvgE>

Please assemble the table **on a soft surface (e.g. a carpet or blanket)** to avoid damages.

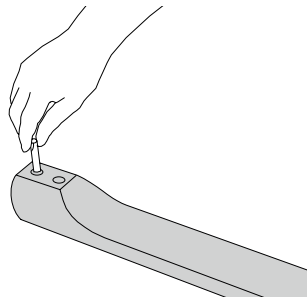

1. Screw in the XS steel dowels.

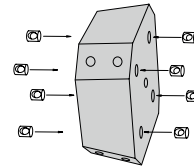

2. Insert the connector housings.



3. Mount the legs to block.

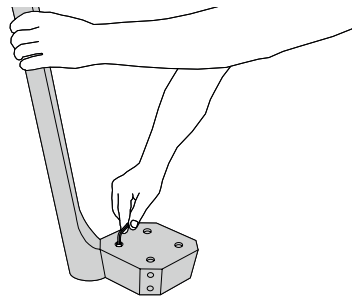

4. Fix the connection from the bottom side with grub screws.

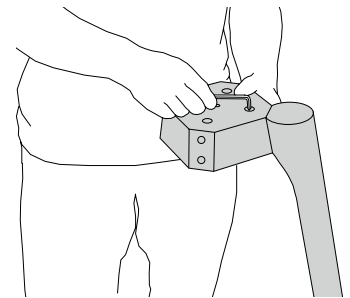

5. Also fix it from the top side with grub screws.

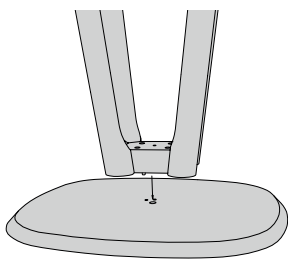

6. Place the frame on the tabletop.

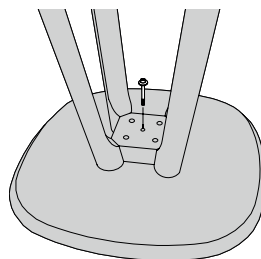

7. Insert the cylinder head screw with flat washer.

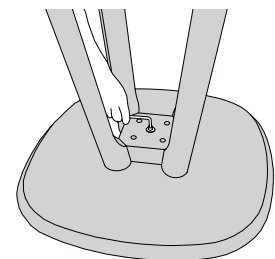

8. Fix the block by screwing it onto the table.