

RAIL Snack

tabletop up to 90x90 cm

ZEITRAUM

Assembly instructions 07/2022

TOOLS:

Allen key SW 5 (enclosed)

6x XS steel dowels (M6)

8x XS steel dowels (M8)

14x connector housings

14x grub screws

1x cylinder head screw (M8x60) with flat washer

1x dowel (8x30)

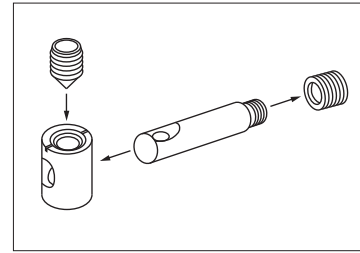
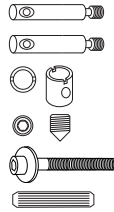

Video:
<http://www.scheulenburg-direkt.de/index.php?page=content&colD=11>

Please assemble the table **on a soft surface (e.g. a carpet or blanket)** to avoid damages.

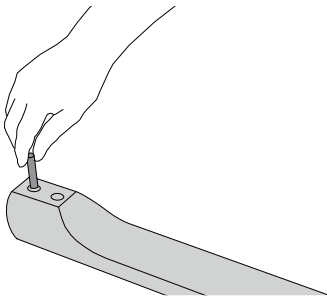

1. Screw in the XS steel dowels (M8).

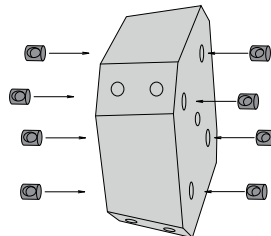

2. Insert the connector housings

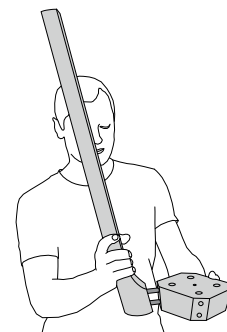

3. Join a leg with the mounting block.

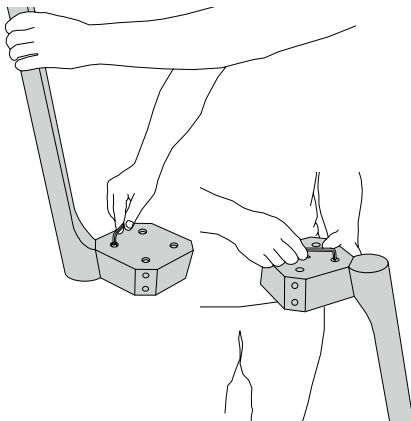

4. Tighten the grub screws on both sides of the block.

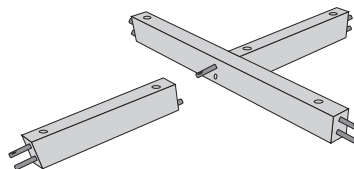

5. For the lower cross, screw in the XS steel dowels (M6) and insert the connector housings. Join the parts and tighten the grub screws.

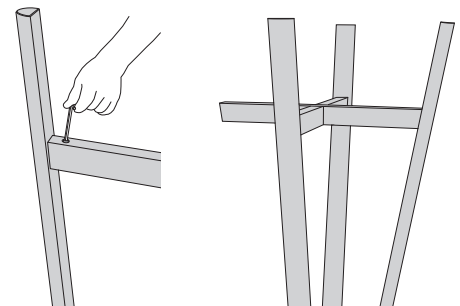

6. Mount the cross to the leg. Afterwards, mount the remaining legs. Assembly is easier when the table is upside down.

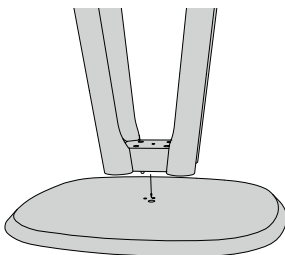

7. Position the legs on the tabletop.

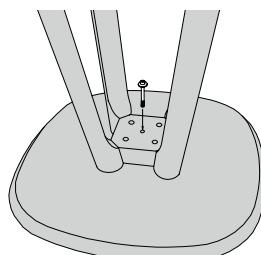

8. Insert the cylinder head screw with the flat washer.

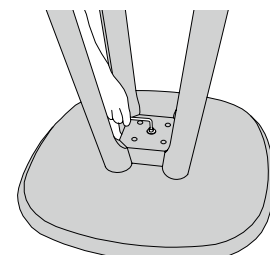

9. Tighten the screw.